

Proposed Project at Mouza-Chakraghata, J.L. No-26, R.S. No-164, R.S. Dag No-742/909, L.R. Dag No-4351, 4377, L.R. Khatian No-3227, 3228, 3426, 3616, 3617, 3619, Ward No-23, Holding No-159/12, Bireshpally (South), under Madhyamgram Municipality, P.S.-Madhyamgram, District-North 24 Parganas

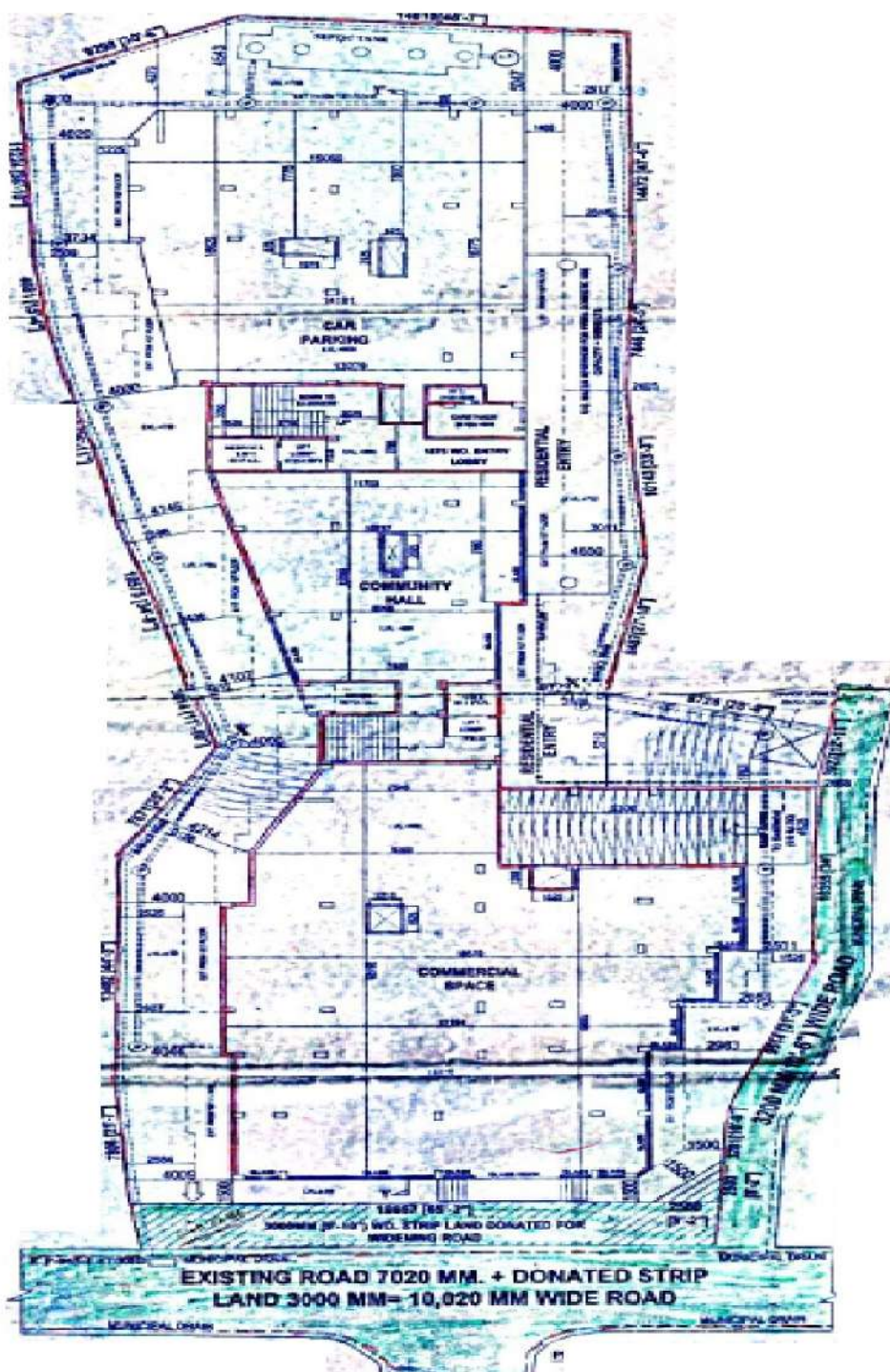

LATITUDE : 22.687081
LONGITUDE : 88.441545

SANGORA REAL ESTATES

Bishal Saha

PARTNER

SIGNATURE OF OWNER